

THE FAIRMONT EMPRESS

Midway between Europe and Asia, anchored on Canada's Western rim and lapped by the waters of the Pacific Ocean, is a place so rich in natural beauty and cultural diversity that the readers of Travel & Leisure rank it the number one island destination in North America. Victoria, the harbourside portal to Vancouver Island and the capital of British Columbia, is the hub of the Pacific Northwest - a region renowned for its unique natural heritage, balmy climate and safe, pristine cities.

Experience the timeless splendour of Victoria at The Fairmont Empress, the grand ivy-covered hotel overlooking the spectacular the Inner Harbour. Built in 1908, The Fairmont Empress has been restored to her turn-of-the-century beauty, with elegant facilities, stately lounges and 477 meticulously decorated guest rooms. The Fairmont Empress' many distinguishing features include:

- Fairmont Gold, a hotel within a hotel
- Conference & meeting facilities, with capacity for up to 500 guests in one venue
- The award-winning Empress Room, a fine dining establishment rich in sophistication and steeped in history
- Kipling's Restaurant, our casual dining room open for breakfast, lunch and dinner
- The Bengal Lounge, Victoria's premier lounge renowned for its curry buffet and signature martini menu
- Afternoon Tea, an Empress tradition since 1908
- Fitness Centre, with indoor pool, hot tub, sauna and work out facility
- Willow Stream, the magnificent Spa at The Fairmont Empress

Steps away from quaint shops, pristine parks, walking trails, ocean adventures and the finest in attractions, shops and dining, The Fairmont Empress boasts the number one address in town! Tour the city's flower-silled streets by horse-drawn carriage or slip away for wilderness adventure. From ocean-bound whale watching to year-round golf, Victoria has a myriad of outdoor activities to choose from. Explore the fascinating exhibits at The Royal BC Museum or be whisked away to the Saanich Peninsula and stroll through the enchanting Butchart Gardens.

In more ways than one, The Fairmont Empress continues to deliver on its promise of offering the best of both worlds. Timeless and new. Leisurely and adventurous. Casual and opulent. The world famous Fairmont Empress awaits you.

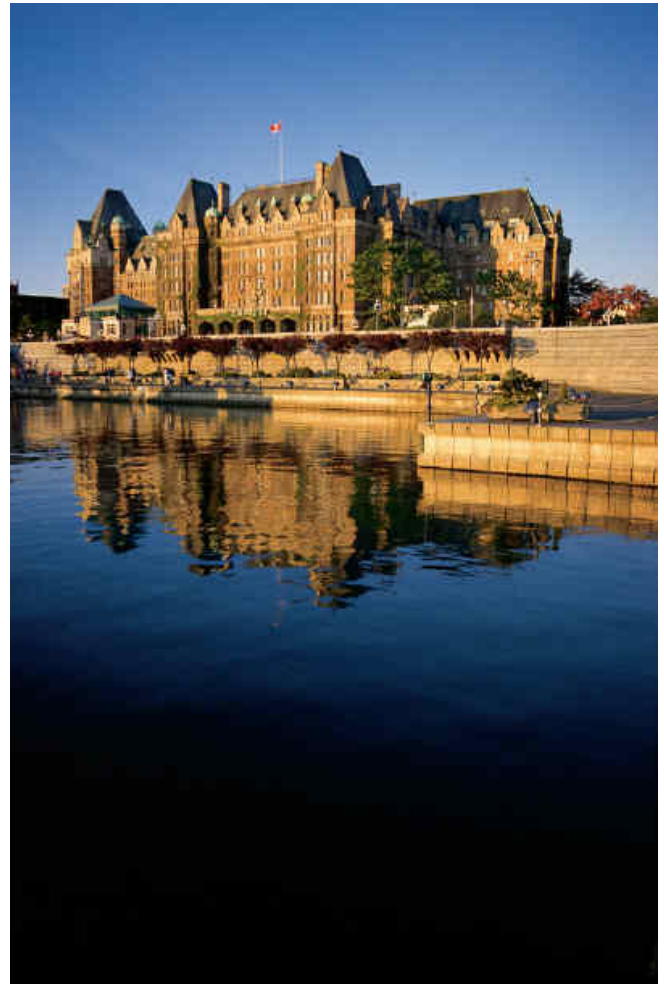

The Fairmont Empress, Charming & Sophisticated

VICTORIA, BRITISH COLUMBIA, CANADA

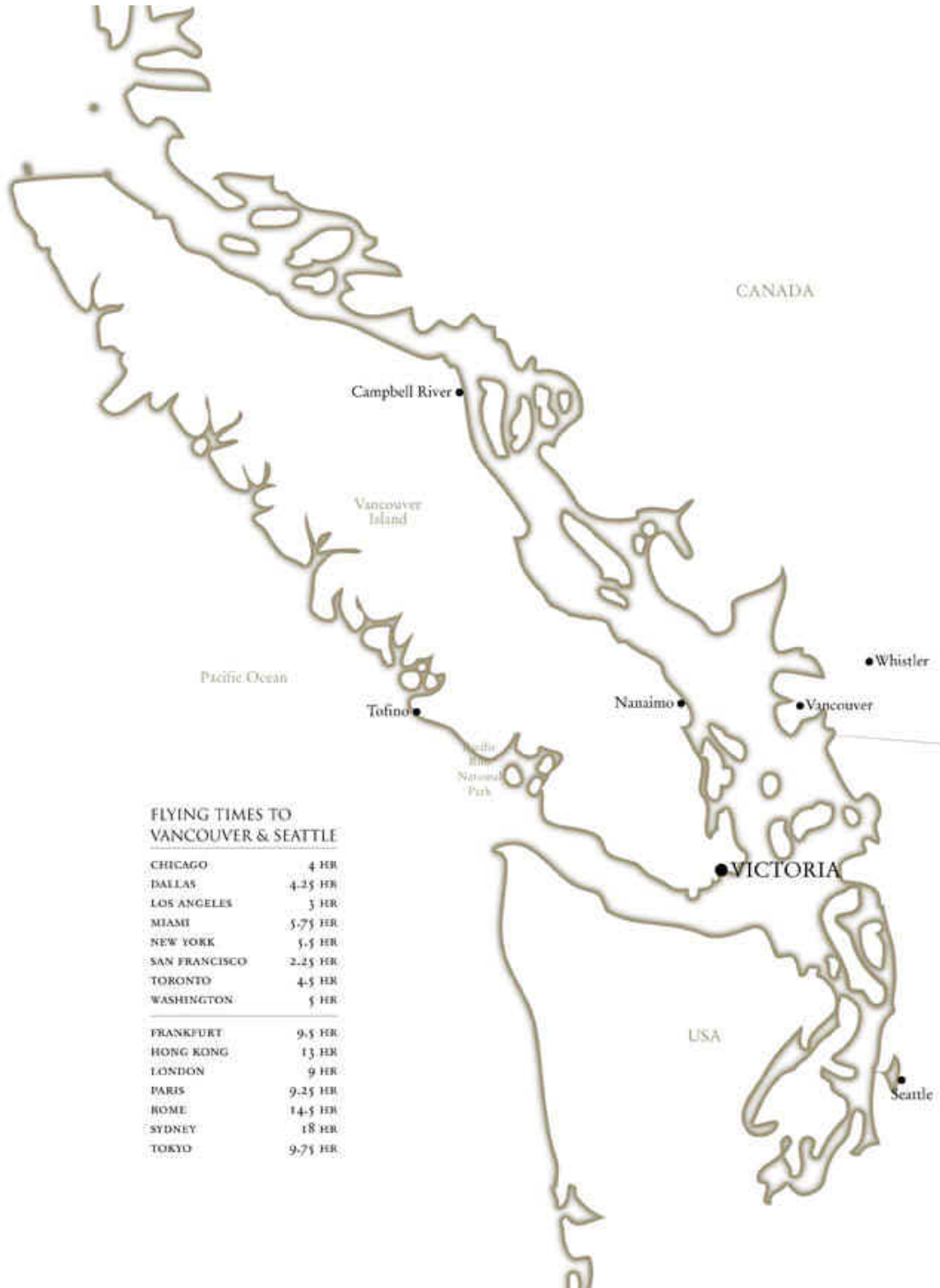

Located in the Heart of the Pacific Northwest

GUEST ROOM ACCOMMODATION

Each of our 477 guest rooms and suites are elegantly appointed, featuring magnificent views of the city, courtyard or the spectacular Inner Harbour. A grand heritage hotel, The Fairmont Empress offers a variety of guest room categories, sizes and configurations.

Fairmont Room

Our classic Fairmont Rooms are furnished in traditional elegant decor and can accommodate up to four people. Each room has a cozy sitting area with two armchairs, some with ample space to accommodate a crib or rollaway.

Bed Type: one King, one Queen, two Doubles or two Twin beds

Size: from 250 to 300 sq. ft.

View: City or inner courtyard



Fairmont Room

Deluxe Room

Our spacious Deluxe Rooms feature traditional elegant decor with large sitting areas with large sitting areas. Excellent for families, these rooms can accommodate up to five people with additional space for a rollaway or crib. The sitting area is furnished with either a sofa, sofa bed or two armchairs. Rooms for the physically challenged are available in this guest room category.

Bed Type: one King, one Queen or two Double beds (Please be advised that the availability of rooms with two Double beds is limited).

Size: from 250 to 275 sq. ft.

View: Harborview



Harbourview Deluxe Room

Harborview Deluxe Room

Our Harborview Deluxe Rooms are elegantly furnished and feature a spectacular view of Victoria's Inner Harbor. Each room is appointed with two armchairs and can comfortably accommodate up to two people.

Bed Type: one King or two Queen beds

Size: from 350 to 400 sq. ft.

View: City or inner courtyard

Common Guest Room Amenities:

- Luxurious down-filled duvets
- Bathrobes (terry-cloth)
- Cable television with in-room pay movies and Sony PlayStation®
- Ceiling fans
- Coffee maker
- Hairdryer
- Iron and ironing board
- Mini-bar
- Telephone with personal voice-mail
- Windows that open to the outside



Harbourview Deluxe Room - Humboldt Wing

LUXURIOUS ACCOMMODATION

Junior Suite

Each of our spacious and luxurious Junior Suites is an open-concept/studio design, elegantly furnished with a sofa bed and distinct sitting area.

Bed Type: one King bed

Size: 500 sq. ft.

View: City

One Bedroom Suite

Each of our spacious One Bedroom Suites features two rooms - a bedroom and parlor with dividing door. The parlor room is lavishly furnished with a sofa bed, some with ample space to accommodate a rollaway bed. Most One Bedroom Suites feature one bathroom, while few are equipped with an additional powder room.

Bed Type: one King bed and a sofa bed

Size: from 650 to 750 sq. ft.

View: City or Harborview

Two Bedroom Suite

Each of our Two Bedroom Suites features three rooms in total - two bedrooms and one parlor. The master bedroom is furnished with one king bed, the second bedroom with two queen beds, and the parlor with a sofa bed and ample space for a rollaway. Each bedroom is equipped with a private bathroom and full amenities.

Bed Type: one King or two Queen beds

Size: 1100 sq. ft.

View: Full or Partial Harborview

Fairmont Gold is designed to meet the needs and expectations of the discriminating business executive and leisure traveler. Dedicated to consistent high-quality service, an attentive concierge team provides the finest level of service and commitment to hospitality excellence. Fairmont Gold guests also enjoy an exclusive lounge with honor bar, complimentary evening hors d'oeuvres and deluxe continental breakfast.

Fairmont Gold Room

Fairmont Gold guest rooms are located on the 1st, 2nd, 3rd and 8th floors. All Fairmont Gold Rooms are non-smoking and offer business amenities, private direct-dial telephone, complimentary business cards, personalized wake-up calls, nightly turn-down service, overnight shoe-shine and morning newspaper delivery. Sorry, no pets.

Bed Type: one King or one Queen bed (a very few rooms have two Double beds)

Size: from 300 to 450 sq. ft.

View: City or Harborview (priced accordingly)



One-Bedroom Suite



Two-Bedroom Suite



Fairmont Gold Room

OUTSTANDING CUISINE

Afternoon Tea

Partake in one of Victoria's grandest traditions - Afternoon Tea at The Fairmont Empress. For over 90 years, the majestic lobby of this landmark hotel has played host to England's most beloved ritual - the taking of Afternoon Tea.

Award-winning Pastry Chef D'oyen Christie works his magic, ensuring an authentic and memorable experience from your very first sip of Empress-blend tea right through to the freshly baked scones, served warm with chantilly cream and strawberry preserves. Presented table-side in the relaxing atmosphere of the lovingly restored Tea Lobby, Afternoon Tea is a 'must do' for all who visit Victoria.



Afternoon Tea

Kipling's Restaurant

A bright, elegant and informal alternative to casual and family dining, Kipling's features a sumptuous breakfast, lunch and dinner buffet, featuring Pacific Northwest regional cuisine and traditional favorites. From fresh BC salmon to a decadent array of desserts, there is something for everyone to savor and indulge in. An la carte menu also available for those wishing to enjoy a lighter fare.



Kipling's Restaurant

The Bengal Lounge

Drawing inspiration from Queen Victoria's role as the Empress of India, this colonial-style lounge is known throughout Victoria for its authentic curry buffet and signature martini menu. Overlooking our stately gardens, the richly appointed Bengal Lounge offers not only a delicious curry lunch and dinner buffet but also an impressive international a la carte menu. Cocktail and martini aficionados will appreciate our vast selection of signature drinks with names such as the Bengal Tiger, Hemingway Special, Ivory Hunter and the Tigertini, to name just a few.



The Bengal Lounge

The Empress Room

Recent recipient of the prestigious Wine Spectator's 'Best of Award of Excellence', this magnificent dining room boasts an extensive wine list of over 800 domestic and international selections, paired with exceptional 4-diamond cuisine. Our Executive Empress Room Chef will surpass your wildest expectations with an eclectic mix of traditional favorites prepared with a unique and international edge.



The Empress Room

LEISURE ACTIVITIES

Willow Stream, The Spa at The Fairmont Empress

With the arrival of the \$6 million Willow Stream spa, guests may now address the finer points of their personal wellness during their stay at The Fairmont Empress. Every inch of the new spa, from its arrival area and changing rooms to the treatments themselves, has been carefully designed to capture the stunning contrasts of Vancouver Island. Exceptionally high standards, luxurious surroundings and exquisite service makes the Willow Stream experience unforgettable. Welcoming seasoned spa-goers and the uninitiated alike, Willow Stream caters to both men and women.



Hungarian Mineral Pool

Take Your Game to a Higher Level

Slip away for a round of golf at one of the hotel's affiliated courses, breathtaking Olympic View or seaside Cordova Bay. Tucked away in a pastoral valley, award-winning Olympic View Golf Course defies golfers to keep their eye on the ball with expansive views of the Olympic Mountains, two magnificent waterfalls, a dozen lakes and island wildlife. Cordova Bay's scenic vistas of Haro Strait, the San Juan Islands and Mount Baker will stop golfers in their tracks. Guests ranging from the novice-level player to the touring professional will find each of these courses a fine test of golf.

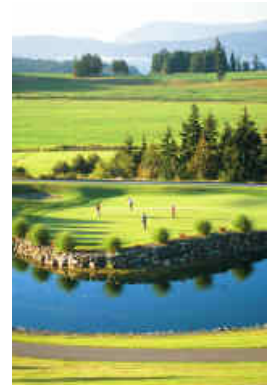

Olympic View Golf Course

Whale Watching Safari

Embark on an exhilarating West Coast adventure with an ocean-bound whale watching safari. Running on pure adrenaline, you will be lifted toward the horizon in a rush of sea and spray. Watch orcas frolic and leap along side an open zodiac or perhaps skim the waves with a school of porpoise. Closer than you ever thought possible, you will never again be as touched by the great outdoors as this.



Whale Watching Safari

SIGHTSEEING & ATTRACTIONS

The Butchart Gardens

The world-famous Butchart Gardens boasts fifty-five acres of wonderful floral display, meandering paths and expansive lawns. From the exquisite Sunken Garden to the charming Rose Garden, the gracious traditions of the past are carefully maintained. Truly one of the loveliest corners in the world, The Butchart Gardens is always in season.



Butchart Gardens

Royal BC Museum & National Geographic IMAX Theater

The Royal British Columbia Museum is a place of discovery. Three unique galleries showcase the human and natural history of British Columbia, and feature periodic exhibitions of international acclaim. Highly realistic and inviting displays, such as the Ice Age and Coastal Forest dioramas, provide visitors with a sense of having truly experienced the authentic settings. Come and explore, a learning adventure awaits you.



Museum Entrance

Craigdarroch Castle

Experience the magic of history with a visit to Craigdarroch Castle. Built in the late 1800's by Robert Dunsmuir, the mansion features magnificent woodwork, period furnishings, and the most prominent collection of stained and leaded glass on the West Coast.

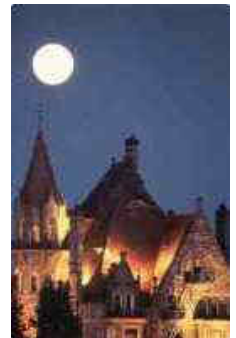

Craigdarroch Castle

Chinatown

Enter Canada's oldest Chinatown through the Gate of Harmonious Interest. Shop for art, curios, home furnishings and Asian wares, then stroll down Fan Tan Alley, North America's narrowest street. Once notorious for its many opium dens and gambling houses, Fan Tan Alley is now lined with shops and restaurants.



Chinatown Gates

MEETING/BANQUET FACILITIES

The Fairmont Empress, together with the adjoining Victoria Conference Centre provides the best of both worlds for a successful business meeting, convention or trade show. Combined, these two facilities offer an unrivaled blend of grand 19th Century hospitality and sophisticated 21st Century technology.



The Tea Lobby

The Fairmont Empress, recently restored to its original grandeur, boasts six meeting rooms with 10,000 square feet of meeting space, crowned by the historic Crystal Ballroom. All rooms provide a natural ambience suitable for corporate meetings, receptions or dinners.



The Crystal Ballroom

The Victoria Conference Centre offers an additional 40,000 square feet of meeting space, equipped with state-of-the-art presentation technology and business support services. The Centre's innovative two-level design provides a wide range of sixteen multi-purpose meeting rooms. Level One includes a 400 seat lecture theatre, six meeting rooms and a VIP suite. Level Two features three reception areas, a further six meeting rooms and a 14,190 square foot assembly hall, accommodating up to 1,450 delegates in theatre-style seating or up to 100 8x10' exhibit booths.



Lecture Theatre

The Victoria Conference Centre

MEETING ROOM FLOOR PLANS

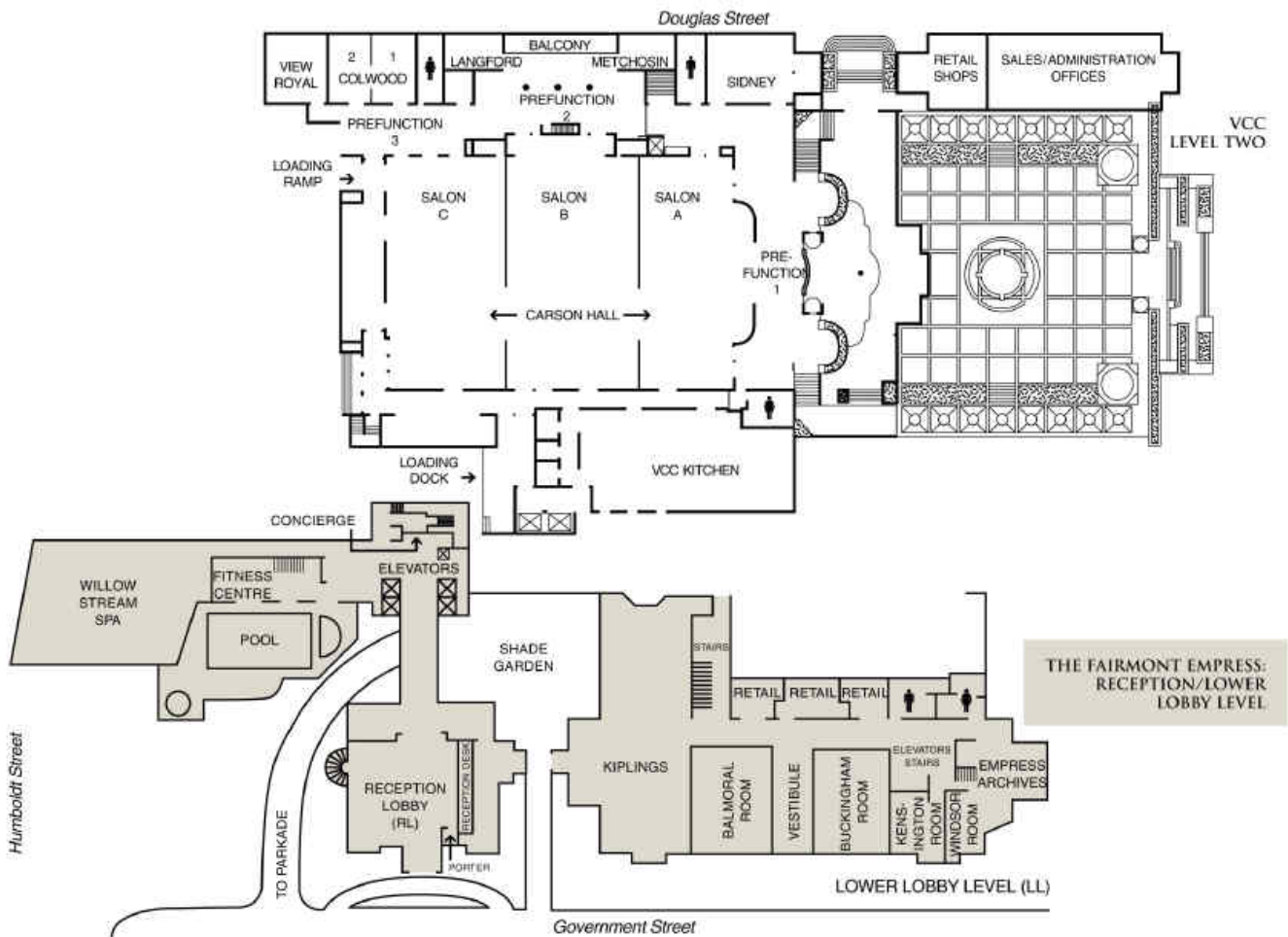

The Fairmont Empress Lower/Reception Lobby Level & Victoria Conference Center Level II

MEETING ROOM FLOOR PLANS

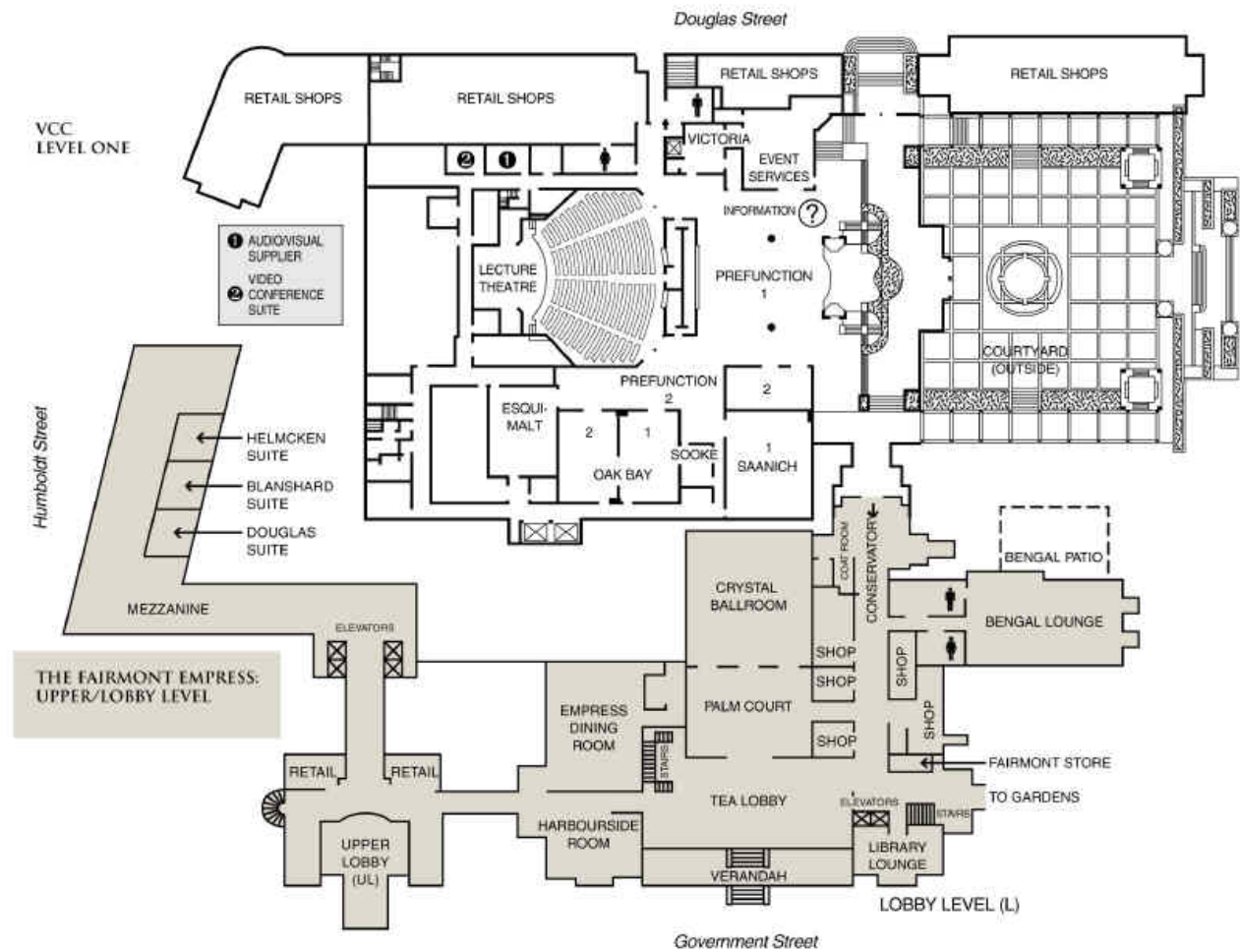

The Fairmont Empress Upper Lobby Level & Victoria Conference Center Level I

MEETING ROOM SPECIFICATIONS

THE FAIRMONT EMPRESS SPECIFICATIONS

ROOMS	OVERALL DIMENSIONS		AREA		HEIGHT		CAPACITY	CAPACITY	CAPACITY	CAPACITY	CAPACITY	CAPACITY
	FEET	METRES	SQ. FT.	SQ. M.	FEET	METRES	BOARDROOM	CLASSROOM	THEATRE	RECEPTION	BANQUET	U-SHAPE
FAIRMONT EMPRESS												
Crystal Ballroom	85 x 40'	26 x 14.8	4,560	423.4	22'	6.7 m	60	300	450	500	370	50
Patio Court	48 x 44'	15 x 13.3	2,136	202.5	19'	5.8 m	---	---	---	300	80	---
Buckingham Room	46 x 30'	14 x 9.1	1,380	127.4	13'	4 m	22	30	70	110	60	20
Baroness Room	46 x 30'	14 x 9.1	1,380	127.4	13'	4 m	32	30	70	110	60	30
Kensington Room	18.5 x 19.5'	6 x 6	364	34	13'	4 m	16	16	24	35	20	14
Walter Room	13' x 13'	4 x 4	169	16	13'	4 m	10	---	---	---	---	---

ADDITIONAL SPACES: **Holbeck Suite:** 26 x 18' / 416 sq ft / 38.4' ceiling / Boardroom - 10. **Blackwood Suite:** 26 x 18' / 416 sq ft / 9' ceiling / Boardroom - 10. **Douglas Suite:** 26 x 18' / 416 sq ft / 9' ceiling / Boardroom - 10.

VICTORIA CONFERENCE CENTRE SPECIFICATIONS

ROOMS	OVERALL DIMENSIONS		AREA		HEIGHT		CAPACITY	CAPACITY	CAPACITY	CAPACITY	CAPACITY	CAPACITY
	FEET	METRES	SQ. FT.	SQ. M.	FEET	METRES	BOARDROOM	CLASSROOM	THEATRE	RECEPTION	BANQUET	U-SHAPE
LEVEL ONE												
Lecture Theatre	---	---	3,200	340	---	---	---	---	400	---	---	---
Stanich	82 x 38'	25 x 11	3,220	300	9' 5"	2.92	72	132	188	225	130	60
Suzanne 1	44 x 35'	13.5 x 11	1,575	145	9' 5"	2.92	54	64	128	150	120	42
Suzanne 2	36 x 18'	11 x 5.5	648	60	9' 5"	2.92	28	36	72	85	90	30
Oak Bay	60 x 37'	18 x 11.3	2,220	207	9' 5"	2.94	58	98	168	200	120	42
Oak Bay 1	37 x 25'	11.5 x 7.5	870	80	9' 5"	2.94	28	54	70	90	60	38
Oak Bay 2	37 x 25'	11.5 x 7.5	870	80	9' 5"	2.94	36	54	70	90	60	38
Excerpt	38 x 29'	11.5 x 7.5	1,040	97	9' 5"	2.96	42	60	84	110	60	38
Dove	13' x 19'	4 x 5.5	230	22	9' 5"	2.94	10	---	---	---	---	---
Victoria	23 x 18'	7 x 5.5	400	37	9'	2.74	18	30	36	46	30	---
Profection 1	---	---	9,500	800	9' 8"	2.97	---	---	---	400	240	---
LEVEL TWO												
Canon Hall	150 x 35'	45 x 28	5,250	485	22'	6.62	---	730	1450	3000	1080	---
Salon A	35 x 30'	29 x 16.5	4,890	450	23'	6.92	82	370	490	600	360	64
Salon B	100 x 40'	31 x 14.5	4,810	445	23'	6.92	83	370	490	600	360	64
Salon C	30 x 40'	29 x 14.5	4,330	400	23'	6.92	82	352	490	600	340	64
Salon A/B	87 x 103'	30 x 31	9,060	837	23'	6.92	---	358	1040	1320	850	---
Salon B/C	87 x 80'	30 x 38	9,340	870	23'	6.92	---	340	1000	1230	810	---
Salon	36 x 29'	11 x 8.5	1,030	96	11'	3.07	40	60	85	110	60	32
Colonnade	38 x 23'	11 x 6.5	1,045	97	11'	3.31	40	57	84	110	60	30
Colonnade 1	20 x 18'	6.5 x 5.5	570	48	11'	3.31	20	24	40	50	30	20
Colonnade 2	20 x 18'	6.5 x 5.5	570	48	11'	3.31	20	24	40	50	30	20
Longport	24 x 15'	7 x 4.5	360	32	11'	3.29	20	18	30	38	200	---
Holbeck	24 x 15'	7 x 4.5	360	32	11'	3.29	20	18	30	34	20	---
View Royal	28 x 24'	8.5 x 7	670	60	11'	3.29	35	36	50	65	40	20
Profection 2	---	---	2,800	270	11'	3.03	---	---	---	800	570	---

ADDITIONAL SPACES: **Video Conference Suite:** 12 x 11' / 137 sq ft / 8' ceiling / Boardroom - 10. **Tatum Profection:** 110 x 23' / 2,490 sq ft / 40' ceiling / Reception - 200 / U-Shape - 60. **Concord (Outside):** 100 x 95' / 29 x 27 m / 8,000 sq ft / 740 sq m / Reception - 700 / U-Shape - 340. **Meeting Planning Office:** 13 x 6' / 78 sq ft / 7' ceiling.

MEETING ROOM SPECIFICATIONS

VICTORIA CONFERENCE CENTRE SPECIFICATIONS

ROOMS	OVERALL DIMENSIONS		AREA		HEIGHT		CAPACITY BOARDROOM	CAPACITY CLASSROOM	CAPACITY THEATRE	CAPACITY RECEPTION	CAPACITY BANQUET	CAPACITY U-SHAPE
	FEET	METRES	SQ.FT	SQ.M	FEET	METRES						
LEVEL ONE												
Lecture Theatre	***	***	3,700	340	***	***	***	***	400	***	***	***
Saanich	62' x 36'	19 x 11	2,230	205	9' 5"	2.82	72	132	180	225	150	60
Saanich 1	44' x 36'	13.5 x 11	1,570	145	9' 5"	2.82	54	84	126	150	120	42
Saanich 2	36' x 18'	11 x 5.5	640	60	9' 5"	2.82	28	36	50	65	30	20
Oak Bay	50' x 37'	15 x 11.5	1,850	170	9' 5"	2.84	56	96	168	200	120	42
Oak Bay 1	37' x 25'	11.5 x 7.5	910	85	9' 5"	2.84	36	54	70	90	60	28
Oak Bay 2	37' x 25'	11.5 x 7.5	910	85	9' 5"	2.84	36	54	70	90	60	28
Esquimalt	38' x 28'	11.5 x 7.5	1,040	97	9' 5"	2.86	42	60	84	110	60	32
Sooke	13' x 18'	4 x 5.5	230	22	9' 5"	2.74	10	***	***	***	***	***
Victoria	23' x 18'	7 x 5.5	420	30	9'	2.74	18	20	35	40	20	
Prefunction 1	***	***	6,500	600	9' 9"	2.97	***	***	***	400	240	***
LEVEL TWO												
Carson Hall	150 x 95'	45 x 29	14,190	1315	23'	6.62	***	750	1450	2000	1080	***
Salon A	95 x 55'	29 x 16.5	4,850	450	23'	6.62	82	270	450	600	360	64
Salon B	100 x 48'	31 x 14.5	4,810	445	23'	6.62	82	270	450	600	360	64
Salon C	95 x 48'	29 x 14.5	4,530	420	23'	6.62	82	252	400	600	340	64
Salon A/B	97 x 103'	30 x 31	9,660	930	23'	6.62	***	588	1040	1200	850	***
Salon B/C	97 x 96'	30 x 29	9,340	870	23'	6.62	***	540	1008	1200	810	***
Sidney	36 x 29'	11 x 8.5	1,030	96	11'	3.07	40	60	85	110	60	32
Colwood	36 x 29'	11 x 8.5	1,040	97	11'	3.31	40	57	84	110	60	32
Colwood 1	29 x 18'	8.5 x 5.5	510	48	11'	3.31	20	24	40	50	30	20
Colwood 2	29 x 18'	8.5 x 5.5	510	48	11'	3.31	20	24	40	50	30	20
Langford	24 x 15'	7 x 4.5	350	32	11'	2.79	20	18	30	30	202	***
Melchosisin	24 x 15'	7 x 4.5	350	32	11'	2.79	20	18	30	30	20	***
View Royal	28 x 24'	8.5 x 7	670	60	11'	3.25	28	36	60	60	40	20
Prefunction 2	***	***	2,900	270	11'	3.085	***	***	***	800	170	***

ADDITIONAL SPACES Video Conference Suite: 17 x 11' / 187 sq ft / 8' ceiling / Boardroom – 10. Tolern Prefunction: 110 x 23' / 2,460 sq ft / 40' ceiling / Reception – 200 / U-Shape – 60. Courtyard (Outside): 100 x 90' / 30 x 27 m / 8,000 sq ft / 743 sq m / Reception – 700 / U-Shape – 340. Meeting Planners Office: 13 x 6' / 78 sq ft / 7' ceiling.

TRANSPORTATION BY AIR

Direct flights to the Victoria International Airport arrive daily from Seattle, Vancouver, Calgary and Toronto. In addition, there is regularly scheduled seaplane and helicopter service between Victoria, Seattle and Vancouver. By commercial air carrier, Victoria is just 25 minutes from Vancouver, 35 minutes from Seattle, 2 hours from San Francisco, and 5 hours from either Dallas or New York. The following is a list of airlines that offer regularly scheduled flights to Victoria:

Air Canada

Frequent daily scheduled flights linking Victoria to Vancouver, Calgary and Toronto.

Ph: (604) 688-5515 Web site: <http://www.aircanada.ca>

WestJet Airlines Ltd.

Scheduled flights link Victoria with destinations across Canada.

Ph: (800) 538-5698 Web site:

<http://c0dsp.westjet.com/internet/sky>

Horizon Air

Regular scheduled service between Seattle and Victoria International Airport.

Ph: (800) 547-9308 Web site: <http://www.horizonair.com>

Pacific Coastal Airlines

Scheduled daily flights between Victoria and Vancouver airports as well as service to the West Coast of BC and other Vancouver Island Communities .

Ph: (800) 663-2872 Web site: <http://www.pacific-coastal.com>

Harbour Air Seaplanes

Scheduled daily flights between Victoria and Vancouver and Gulf Island harbors. Daily tours of Victoria, the Gulf Islands, the San Juan Islands and the Olympic Peninsula.

Ph: (604) 688-1277 Web site: <http://www.harbour-air.com>

West Coast Air Ltd.

Scheduled daily flights between Victoria and Vancouver harbors.

Ph: (800) 347-2222 Web site: <http://www.westcoastair.com>

Kenmore Air

Scheduled seaplane service between Seattle and Victoria's Inner Harbor.

Ph: (800) 543-9595 Web site: <http://www.kenmoreair.com>

Helijet International Inc.

Frequent daily flights travel between Victoria and downtown Seattle, downtown Vancouver and the Vancouver International Airport.

Ph: (604) 273-1414

Web site: <http://www.helijet.com>



Direct Flights via Victoria International Airport



Harbor-to-Harbor Seaplane Service



Scheduled Helicopter Service

TRANSPORTATION BY SEA

Regularly scheduled ferry service connects Victoria to mainland British Columbia and Washington State. Each day, dozens of ferries cross the Juan de Fuca strait, providing breathtaking views of the rocky coastline, forested inlets and marine wildlife.

Victoria's arrival points include the Inner Harbour, the Town of Sidney and the Swartz Bay ferry terminal (30 minutes from downtown Victoria). The following is a list of ferries that offer regularly scheduled service to Victoria:

British Columbia Ferries

Frequent daily scheduled service is provided (passengers and vehicles) between Tsawassen (south of Vancouver) and Swartz Bay (north of Victoria) or between Tsawassen and Duke Point (south of Nanaimo). Also, frequent service between Horseshoe Bay (West Vancouver) and Departure Bay (Nanaimo), to the Gulf Islands and other BC points. Full cafeteria service and other amenities are found on main route ships.

Ph: (604) 444-2890

Web site: <http://bcferries.com/schedules>

Victoria Clipper

High-speed passenger service between Seattle's Pier 69 and Victoria's Inner Harbour.

Ph: (800) 888-2535

Web site: <http://www.victoriaclipper.com>

Black Ball Transport

The MV Coho offers scheduled vehicle and passenger service between Port Angeles, WA and Victoria's Inner Harbour.

Ph: (250) 386-2202

Web site: <http://www.northolympic.com/coho>

Victoria San Juan Cruises

Daily passenger-only service between Bellingham, WA and Victoria's Inner Harbour (May to October only).

Ph: (800) 443-4552

Web site: <http://www.whales.com/daycruise.html>

Washington State Ferries

Scheduled vehicle and passenger ferry service between Anacortes, WA and the Town of Sidney (30 minutes North of downtown Victoria).

Ph: (888) 808-7977

Web site: <http://www.wsdot.wa.gov/ferries>



British Columbia Ferries



Victoria Clipper



Victoria Clipper & M/V Coho